

ADI™ Cable Brace Installation Guide

Level - Predrilled Cable Brace

Cable Brace:

- 3/4" x 42"
- 13 Pre-Drilled Holes (3-1/8" on Center)
- Includes Connectors w/ Screws

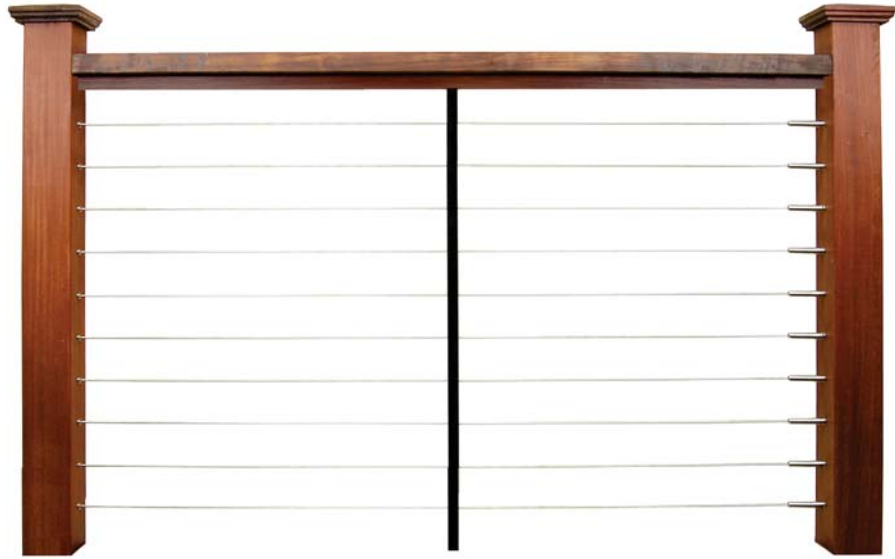

Cable braces are non-structural railing supports designed to help maintain spacing to avoid cable deflection over 4" to keep within code parameters. Designed for wood railing frames (with or without bottom rails) up to 42" high with 13 pre-drilled holes at a 3-1/8" on center spacing.

A vertical support, either post or cable brace, is required every 4ft or less to meet code.
A cable brace can also be used as a drilling template for posts.

Consult local building code for all railing construction requirements in your area.

Step 1

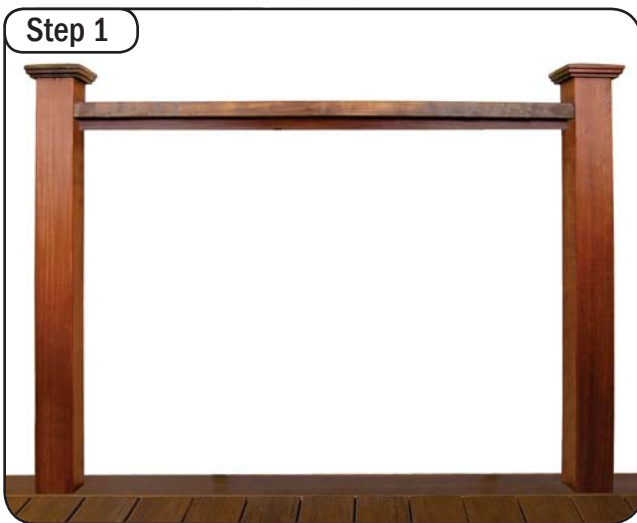

FrameWork

Posts should be set in place. Top rail should be temporarily fastened into place, so the cable brace can be added later.

Step 2

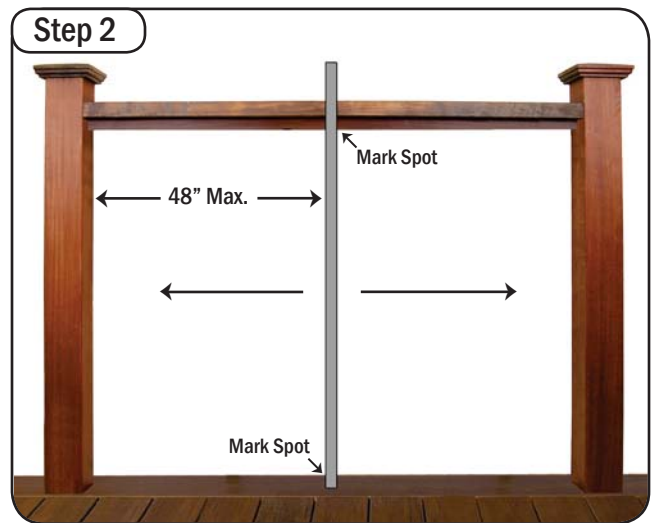

Determine Cable Brace Placement

Center the cable brace between the two post and mark the location on the bottom side of the top rail and the top side of either the deck board or the bottom rail if used. 48" Maximum spacing. (Cable brace must be used if structural posts are spaced over 4 feet apart).

ADI™ Cable Brace Installation Guide

Level - Predrilled Cable Brace

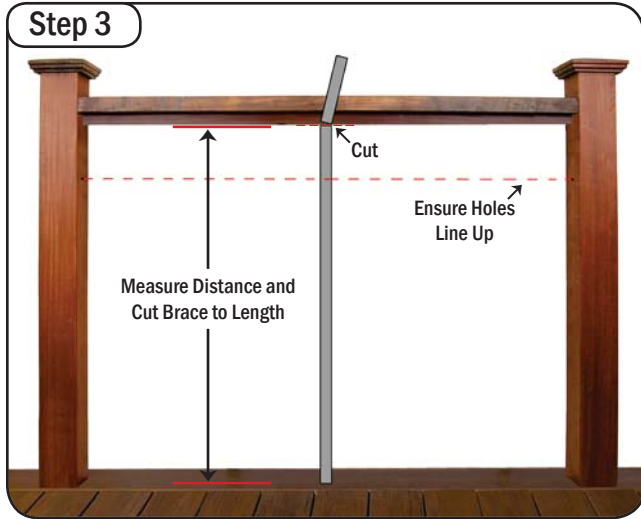

Measure and Cut Cable Brace

Measure the distance between the top rail and deck board (or bottom rail). Center the cable brace and make sure the holes correctly align with the holes drilled in the posts. Then cut to length. (Top and bottom may both have to be cut). **Cable brace can be used as template for hole spacing on posts.**

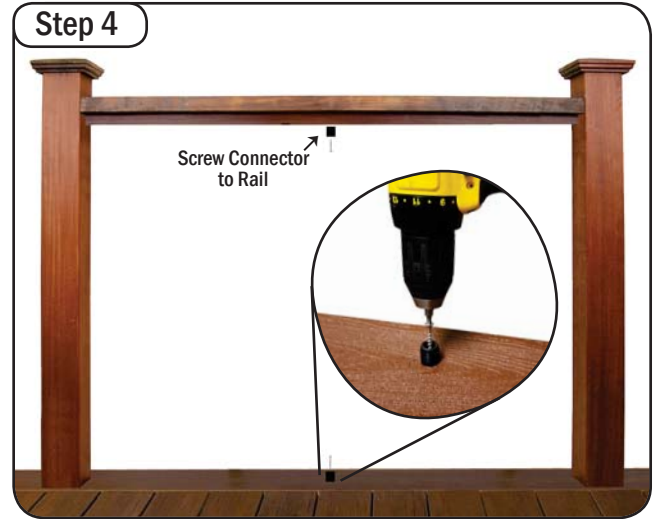

Install Connectors

Install cable brace connectors to the bottom side of the top rail and the top side of either the deck board or the bottom rail if used. (Use the marks made from Step 2)

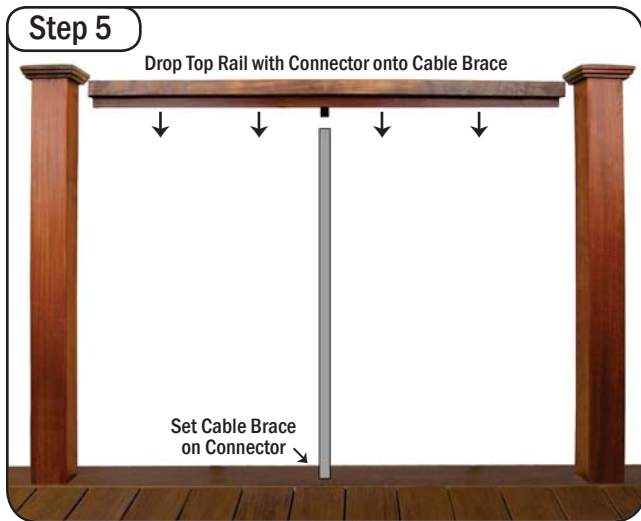

Install Cable Brace

Set cable brace onto bottom connector, then drop the top rail down to attach to cable brace. Permanently attach top rail to posts.



Finish Rail

Once the cable brace is set and the framework is complete, run the cables and tension to complete the rail system.

ADI™ Cable Brace Installation Guide

Stair - Pre-drilled Cable Brace

Cable Brace:

- 3/4" x 50"
- 12 Pre-Drilled Holes (3-1/8" on Center)
- Includes Connectors w/ Screws



Cable braces are non-structural railing supports designed to help maintain spacing to avoid cable deflection over 4" to keep within code parameters. Designed for wood railing frames (with or without bottom rails) up to 42" high with 12 pre-drilled holes at a 3-1/8" on center spacing.

A vertical support, either post or cable brace, is required every 4ft or less to meet code.

Consult local building code for all railing construction requirements in your area.



FrameWork

Posts should be set in place. Top rail should be temporarily fastened into place, so the cable brace can be added later.

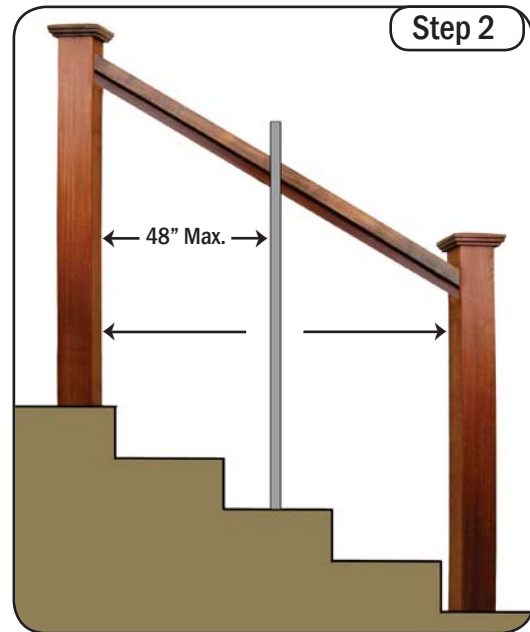

Determine Cable Brace Placement

Center the cable brace between the two post and mark the location. 48" Maximum spacing. (Cable brace must be used if structural posts are spaced over 4 feet apart).

ADI™ Cable Brace Installation Guide

Stair - Predrilled Cable Brace

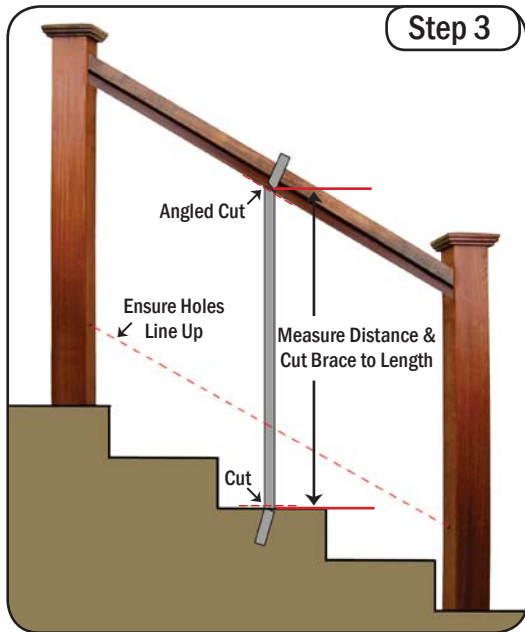

Measure and Cut Cable Brace

Measure the distance between the top rail and stair tread (or bottom rail). Center the cable brace between and make sure it lines up with the holes drilled in the posts. Then cut to length. (Top and bottom will both have to be cut)

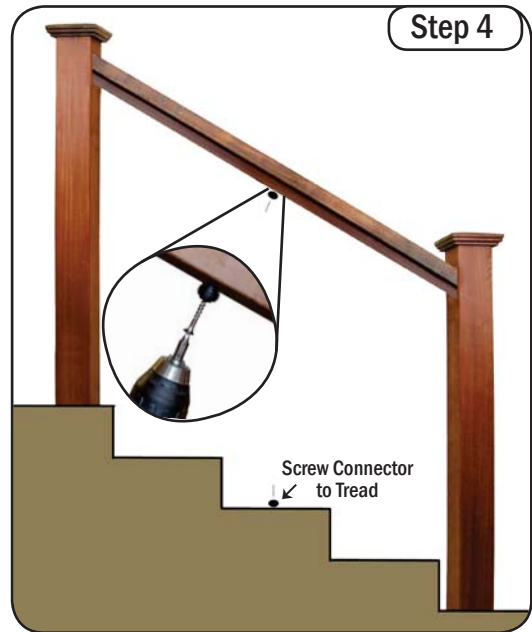

Install Ball Connectors

Install cable brace connectors to the bottom side of the top rail and the top side of either the stair tread or the bottom rail if used.

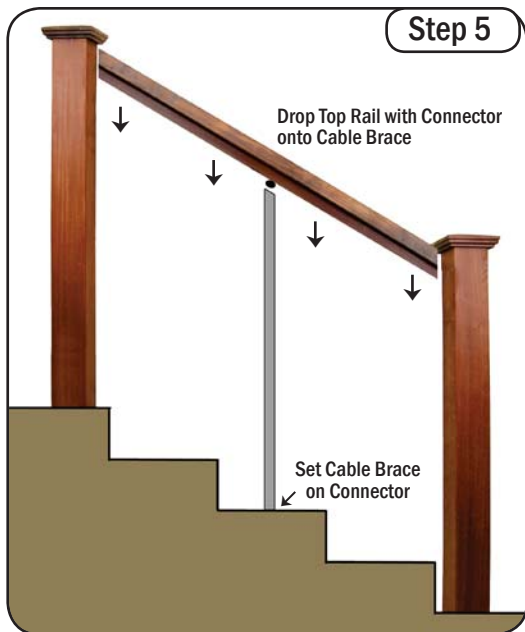

Install Cable Brace

Set cable brace onto bottom connector, then drop the top rail down to attach to cable brace. Permanently fix top rail to posts.



Finish Rail

Once the cable brace is set and the framework is complete, run the cables and tension to complete the rail system.