

DekPro™ EFFEX In-line Connector Installation Guide

When using a perimeter wire around deck

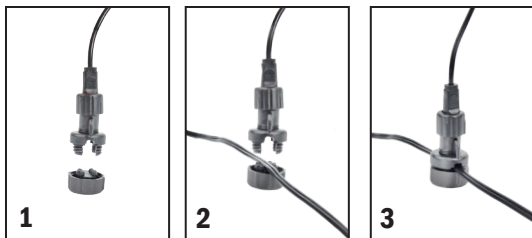

Step 1

Unscrew In-line connector module.

Step 2

Align In-line connector with perimeter wire.

Step 3

Screw In-line connector together until wire is fully pierced and cap fully seated.

Note: Ensure correct wire polarity is maintained during installation

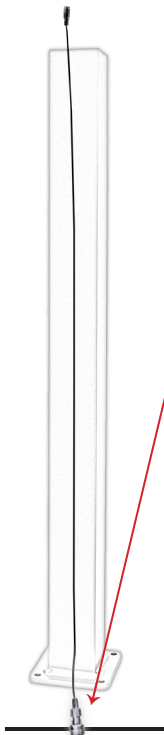



DekPro™ EFFEX Product Warranty

Should any product fail DekPro™ EFFEX reserves the right to request return of the product, transportation costs pre-paid, for the purpose of inspecting the product to determine validity of the claim. Upon validation of a claim by DekPro™ Manufacturing, replacement will be sent including transportation costs. Code compliance and applicability for intended use is the responsibility of purchaser / installer.

EXCEPT AS OTHERWISE PROVIDED, DekPro™ Manufacturing MAKES NO OTHER WARRANTIES, EXPRESSED OR IMPLIED, INCLUDING BUT NOT LIMITED TO THE WARRANTIES OF MERCHANTABILITY AND FITNESS FOR A PARTICULAR PURPOSE. THIS WARRANTY IS NOT TRANSFERABLE.

DekPro™ Manufacturing's liability is discharged upon repair or replacement of defective product. DekPro™ Manufacturing will not be responsible for cost of removal and reinstallation or accidental and consequential damages. Damages resulting from misuse, abuse, alteration, negligence or accidents are not covered under this warranty.

For full warranty coverage details visit www.dekpromfg.com



DekPro Manufacturing Inc.
P.O. Box 18566
Minneapolis, MN 55418
1-855-433-5776